

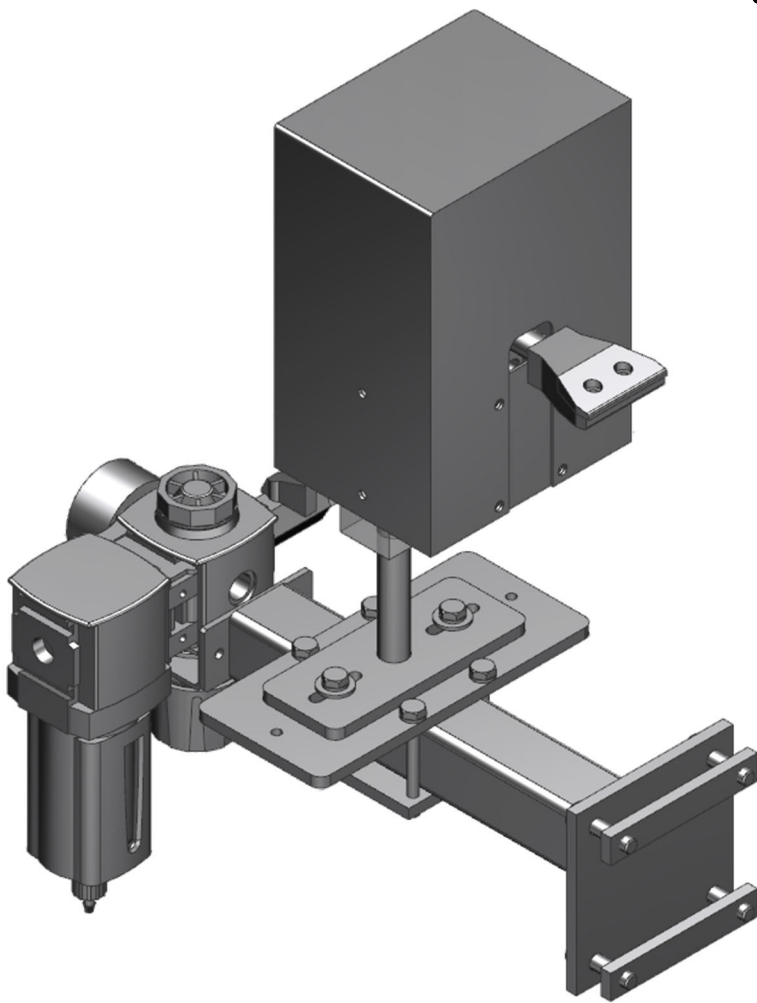

SILGAN
EQUIPMENT

AIR TOUCH 600 DIVERTER OPERATING MANUAL

NOVEMBER 2022



SILGAN EQUIPMENT

1301 DUGDALE ROAD

WAUKEGAN, IL 60085

847-336-0552

847-336-0562 FAX

WWW.SILGANEQUIPMENT.COM

AIR TOUCH 600 - OPERATING MANUAL TABLE OF CONTENTS

Section Number	Description	Page Number
1.0	ADJUSTMENT	1-1
1.1	ADJUSTMENT OVERVIEW	1-1
1.1.1	NOZZLE POSITION AND AIR PRESSURE ADJUSTMENTS	1-2

1. ADJUSTMENT

1.1 Adjustment Overview

Operating Pressure Range

The operating pressure range is between 55psi minimum and 115psi maximum.

Prerequisite

The Air Touch 600 must be mounted to the conveyor and connected to a Vision system. The Air Touch 600 must also be connected to an air supply.

Tools Required

The only tool required to make adjustments to the Air Touch 600 is a 7/16" wrench.

1. ADJUSTMENT

1.1.1 Nozzle Position and Air Pressure Adjustments

Nozzle Distance To Conveyor

To adjust the air discharge nozzle distance to the conveyor, loosen four bolts (*Item 1*). Slide the nozzle unit toward or away from the conveyor as needed (*Figure 1-1*). When the nozzle is at the ideal distance, tighten the four bolts (*Item 1*).

Note: Avoid any adjustment positions where the product can collide with the nozzle.

Nozzle Lateral Position

To adjust the lateral position of the nozzle, loosen two bolts (*Item 2*). Move the unit laterally until the ideal position is reached (*Figure 1-1*). Tighten the two bolts (*Item 2*).

Note: Multiple tapped holes are available to adjust the "rough" position. The slots are available to adjust the "fine" position.

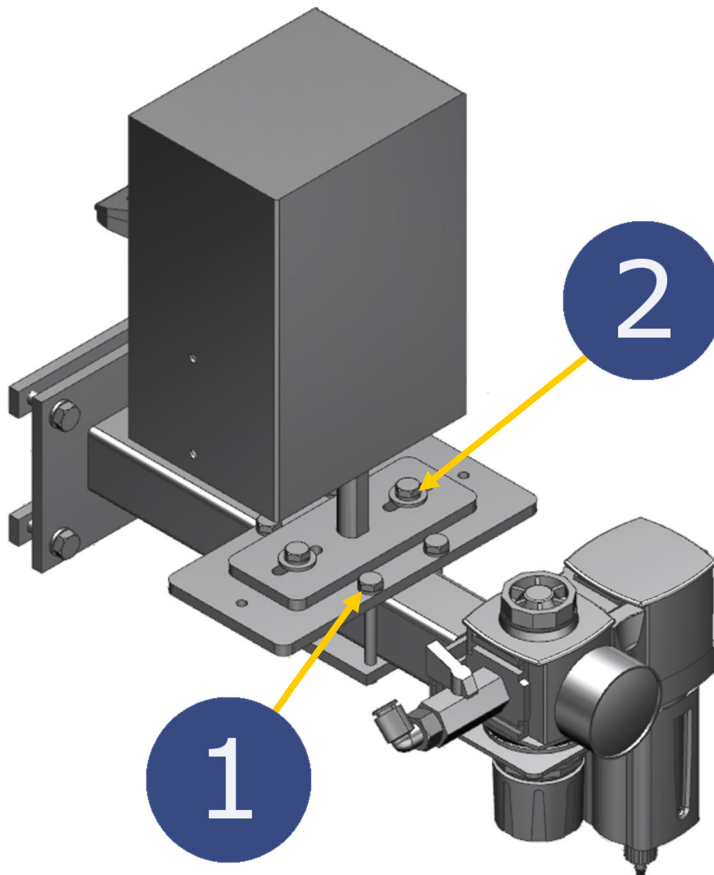

Figure 1-1: Nozzle Distance and Lateral Adjustments

1. ADJUSTMENT

Adjust nozzle height.

To adjust the height of the nozzle, loosen the bolt (*Item 3*) just under the unit (*Figure 1-2*). Move the nozzle head up or down until it is in the ideal position. Tighten the bolt, but do not over torque.

Note: For best results, the nozzle should be positioned at the middle of the product.

Air Pressure Adjustment

To adjust the air pressure supplied to the nozzle, use pressure regulator. Gradually increase air pressure as needed. Higher air pressure results in a higher force applied by the nozzle.

Valve Activation Time

To adjust the valve's "on-time duration", use the Vision system user interface.

Note: Readjust settings as needed. The product should be ejected clear from the conveyor without interfering with other packages.

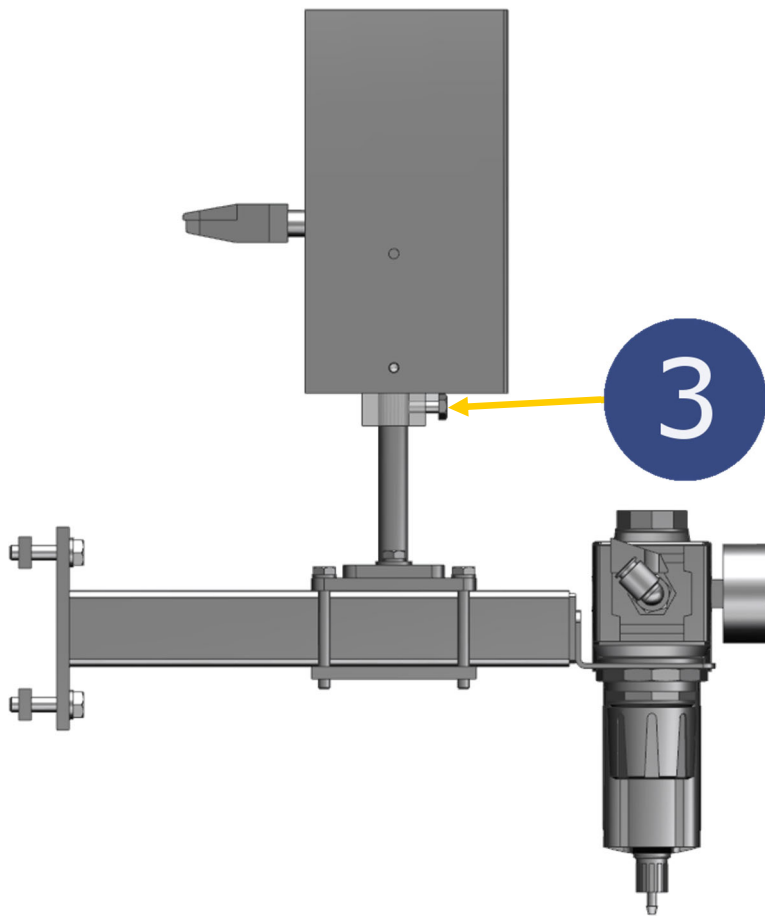

Figure 1-2: Nozzle Height Adjustment